

Community space – room 1

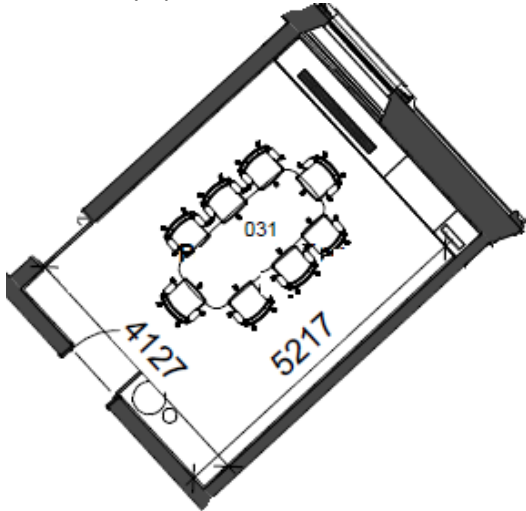

Meeting room capacity: 8 people
Number of chairs: 8

Technical provisions: Access to mobile AV unit is available with prior booking

Room set up: Board room only

Accessible: Close to the front entrance and platform access

Toilets: Male, female and accessible inclusive toilets are available from Reception

Refreshments: There is not public access to the teapoint without prior arrangement

Furniture: Single table and meeting room chairs

Community space – room 2

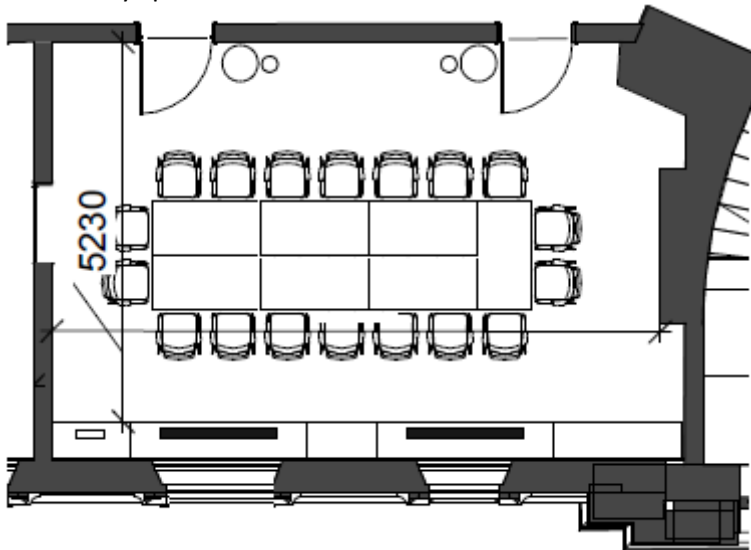

Meeting room capacity: 18 people
Number of chairs: 18

Technical provisions: Access to mobile AV unit is available with prior booking

Room set up: Board room and less formal set ups available

Accessible: Close to the front entrance and platform access

Toilets: Male, female and accessible inclusive toilets are available from Reception

Refreshments: There is not public access to the teapoint without prior arrangement

Furniture: Rectangular folding table that can be moved around and meeting room chairs