

VIP Marquee Layout

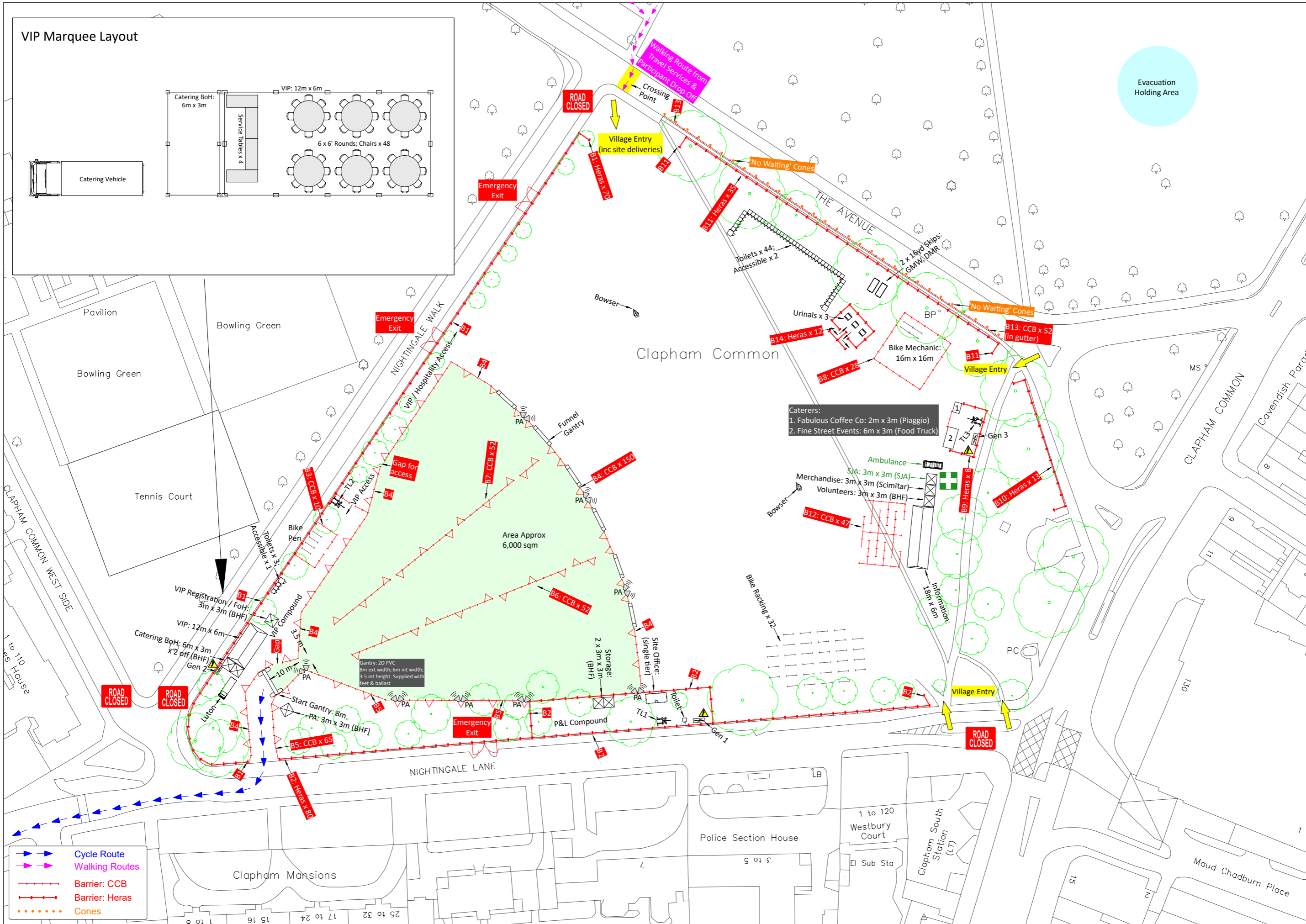
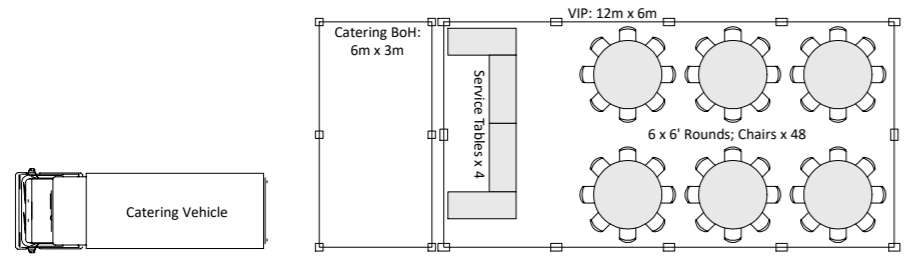

- Cycle Route
- Walking Routes
- Barrier: CCB
- Barrier: Heras
- Cones

Event: London to Brighton 2023
 Drawing: Clapham Common Start
 Scale: 1:1000 @ A3

Version: FINAL
 Date: 30/05/23
 Drawn: TE

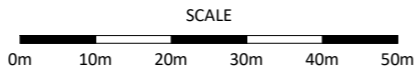





This information must not be copied or distributed without prior consent from the British Heart Foundation. These drawings are for illustrative purposes only. All layouts, specifications, dimensions and locations of infrastructure are provisional until final approval on-site.

British Heart Foundation
 Greater London House, 180 Hampstead Road, London. NW1 7AW
 Tel: 020 7935 0185 bhf.org.uk

ROAD CLOSED

**18th June
00:01 - 23:59**

This information must not be copied or distributed without prior consent from the British Heart Foundation. These drawings are for illustrative purposes only. All layouts, specifications, dimensions and locations of infrastructure are provisional until final approval on-site.

-  Cycle Route
-  Walking Routes
-  Barrier: CCB
-  Barrier: Heras
-  Cones

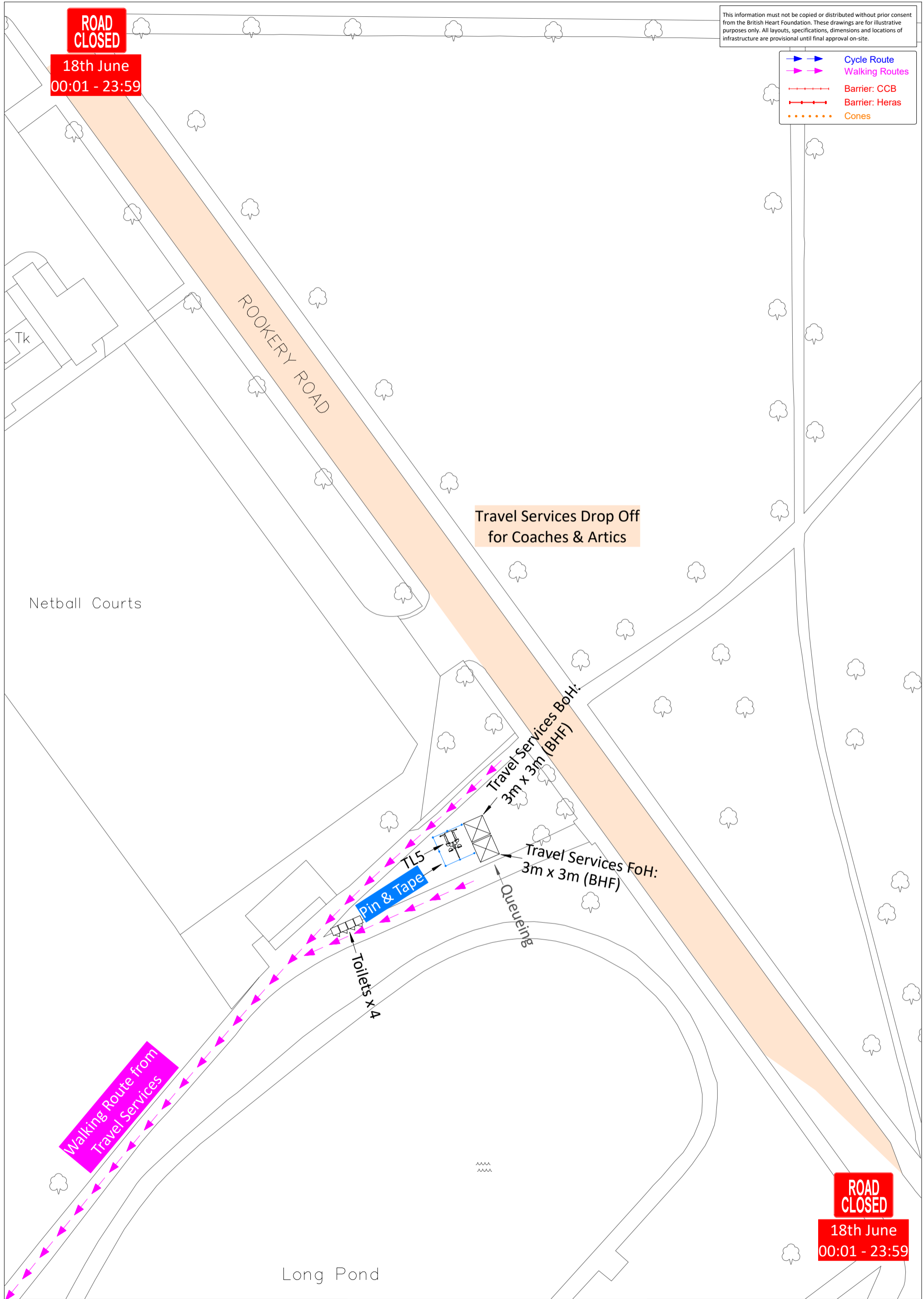

ROAD CLOSED
**18th June
00:01 - 23:59**

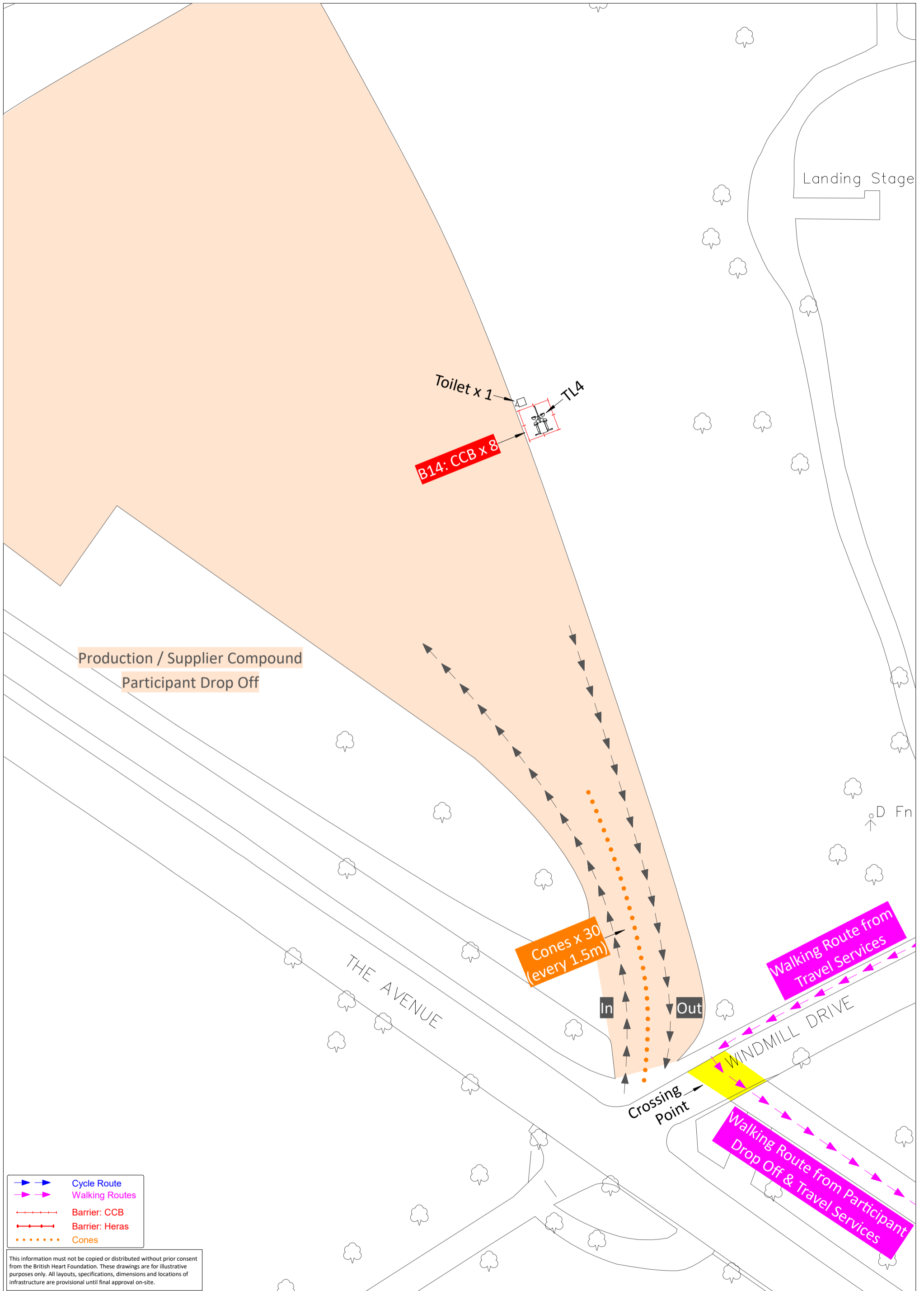

- → Cycle Route
- → Walking Routes
- — — — Barrier: CCB
- — — — Barrier: Heras
- • • • • Cones

This information must not be copied or distributed without prior consent from the British Heart Foundation. These drawings are for illustrative purposes only. All layouts, specifications, dimensions and locations of infrastructure are provisional until final approval on-site.

Event: London to Brighton 2023
 Drawing: Production CP & Participant Drop Off
 Scale: 1:500 @ A3

Version: FINAL
 Date: 30/05/23
 Drawn: TE

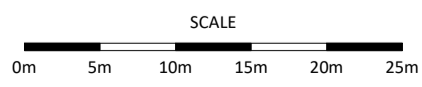

British Heart Foundation
 Greater London House, 180 Hampstead Road, London. NW1 7AW
 Tel: 020 7935 0185 bhf.org.uk